



2016-2018 Focus RS Aluminum Skid Plate

Installation Instructions

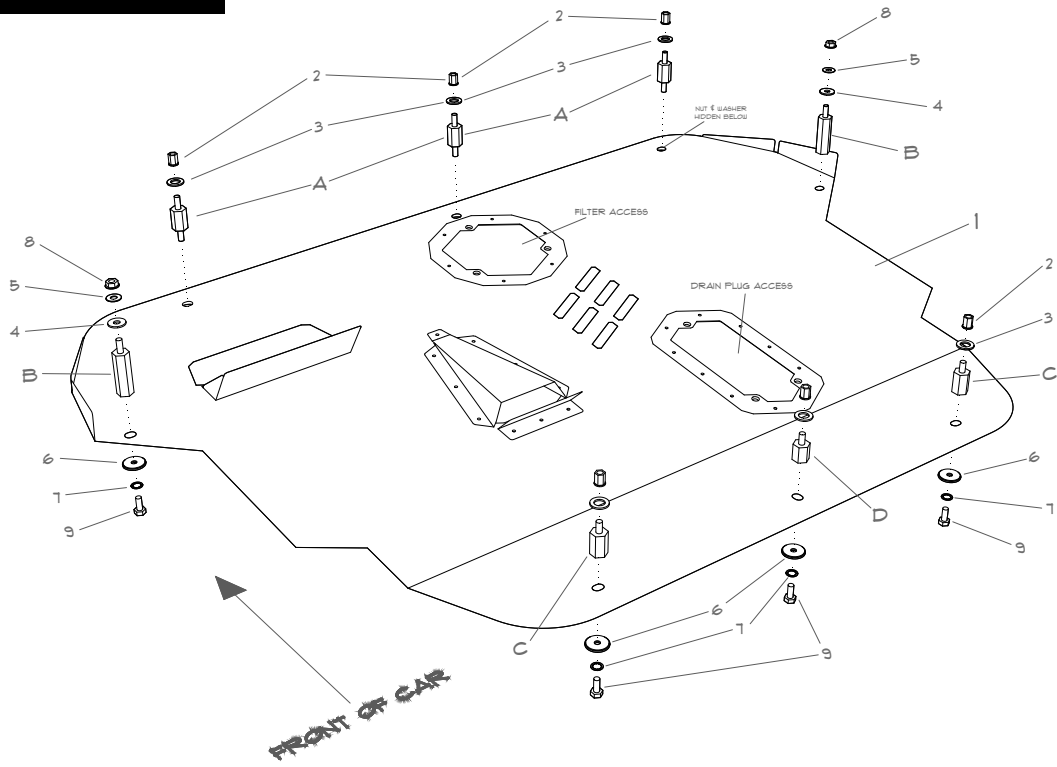

FIGURE 1 - SKID PLATE INSTALLATION PARTS DIAGRAM

Part	Description	Quantity
1	FoRS Skid Plate Assembly	1
2	1/4-20 Rivet Nut	8 (2 extra provided)
A	1" Male-Male Standoff (Fastener A)	3
B	2" Male-Female Standoff (Fastener B)	2
C	1" Male-Female Standoff (Fastener C)	2
D	.75" Male-Female Standoff (Fastener D)	1
3	Wide Rivet Nut Washer (7/16" I.D., 3/4" O.D.)	6
4	Fender Washer (5/16 I.D., 3/4" O.D.)	2
5	Flat Washer (5/16" I.D., 5/8" O.D.)	2
6	Neoprene Bonded Washer	8
7	Lock Washer	5
8	Flanged Nylon Lock Nut	3
9	5/8" Hex Bolt	5

TOOLS NEEDED

Required Tools	Suggested Tools
T30 Torx driver	Ratchet wrench with 7/16" socket
Rivet-nut installation tool with 1/4" mandrel	*Low-strength thread locker
Small flathead screwdriver	
7/16" wrench	
5/8" wrench	

*We suggest using a small amount of low strength thread locker on all threads that attach to the rivet nuts (optional).

INSTALLATION PROCEDURE

Please read entire installation procedure before you begin.

****Always wear safety glasses and appropriate protective equipment when performing these tasks****

- 1. **Remove the OEM engine splash guard/belly pan** using T30 Torx driver. Then, using a small flathead screwdriver, **remove the OEM fasteners** from the subframe and the radiator support. It is only necessary to remove the OEM fasteners from the locations specified in Figure 2.

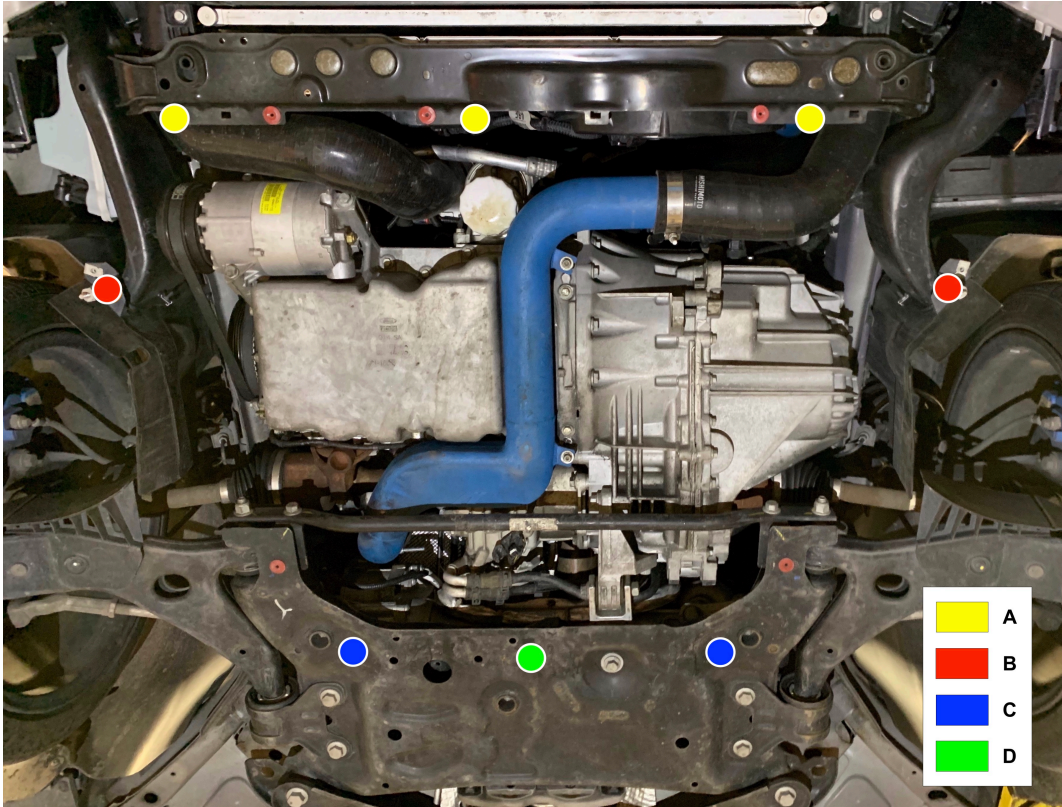

FIGURE 2 - FASTENER LOCATIONS

2. **Install provided rivet nuts** into the holes marked **A, C, & D** in Figure 2. Try to keep them centered in the rectangular holes. This can be done with any rivet nut install tool that will work with 1/4-20 threads.
3. **Install Fastener A standoffs-** Using the wide rivet nut washer, center it over a rivet nut in position **A** (yellow) from Figure 2. Thread one end of **Fastener A** into the rivet nut, ensuring the washer doesn't rest on the rivet nut. See Figure 3 for example. Repeat this for all rivet nuts in position A.
4. **Install Fastener B standoffs-** Slide a large fender washer (3/4" O.D.) onto the male end of **Fastener B**, then insert into the now-empty hole on the fender liner, position **B** (red). Place a small washer (5/8" O.D) and a lock nut on top. Tighten the lock nut with a 7/16" wrench while holding the standoff with a 5/8" wrench. Repeat for opposite side.
5. **Install Fastener C standoffs-** Thread the two **Fastener C** standoffs into the two outside rivet nuts in the subframe, position **C** (blue) in Figure 2, using the same wide rivet nut washer in Figure 3.
6. **Install Fastener D standoff-** Thread the **Fastener D** into the rivet nut in the center of the subframe, position **D** (green) from Figure 2, using the same wide rivet nut washer as in Figure 3.
7. **Tighten all standoffs** with a 5/8" wrench.
8. **Install Skid Plate-** Place skid plate over the front 3 studs. Slide bonded washers over the studs (this should hold the plate up on its own to make installation easier), followed by the flanged nylon lock nuts. Use the 5/8" bolts with the supplied bonded washers and lock washers on the back 3 standoffs. Then, install the two 5/8" bolts into the Fastener B locations (the fender liners may need to move slightly to line up perfectly).
9. When all of the fasteners are in place, **tighten the nuts and bolts** with a 7/16" wrench or socket, ensuring not to over-torque. The rubber on the bonded washers will slightly bulge out.
10. **Enjoy** your new skid plate and the added protection!!



FIGURE 3 - WASHER POSITIONING FOR LOCATION A, C & D

Thank you for choosing ADF Customs! We appreciate your business. Should you have any questions, issues or feedback, please email us at: info@adfcustoms.com

If you are happy with your ADF Customs product and customer experience, please leave a review or share online via your favorite forum, Facebook or Instagram.