



2012-2018 Focus MK3 Drag Wing Installation Instructions

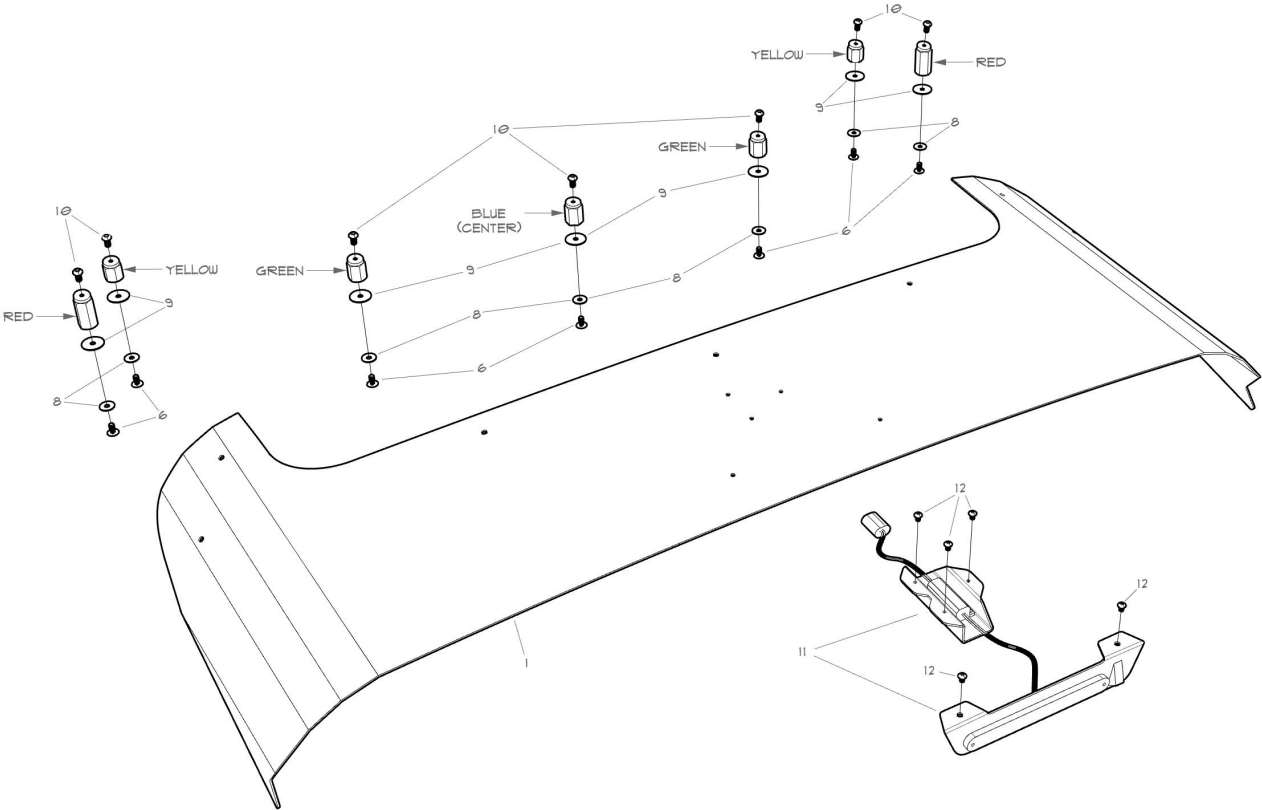

FIGURE 1 - DRAG WING INSTALLATION PARTS DIAGRAM

Part	Description	Quantity
1	Focus MK3 Drag Wing	1
2	Red Standoff	2
3	Yellow Standoff	2
4	Green Standoff	2
5	Blue Standoff	1
6	6mm x 12mm Flanged Torx Screw	7
7	Lock Washer	7
8	Flat Washer	7
9	Neoprene Washer	7
10	6mm x 10mm Hex-Drive Screw	7
11	Tail Light Assembly	1
12	8-32 x 1/4" Hex-Drive Screw	5

TOOLS NEEDED

Required Tools	Suggested Tools
T20 Torx Driver	Battery-Operated or Ratcheting Screwdriver
T30 Torx Driver	Panel removal tool
4mm Hex Driver or Allen Wrench	
3/32"Hex Driver or Allen Wrench	
8mm Socket Wrench	
3/4" or 20mm Open-End Wrench	

INSTALLATION PROCEDURE

Please read entire installation procedure before you begin.

****Always wear safety glasses and appropriate protective equipment when performing these tasks****

1. Remove OEM wing.

- a. Start by removing the tail light. Remove the two T20 torx screws holding the tail light and pull the tail light out. Disconnect the washer fluid hose and electrical connector from the back of the tail light.
- b. Open tail gate. There are seven screws connecting the OEM wing. Four T20 torx screws are immediately accessible, two on the driver's side and two on the passenger side. Remove the central plastic cover (above the rear window) to gain access to the remaining three screws. Use the 8mm socket wrench to remove them. Refer to **Figure 2** for fastener locations.
- c. When all seven screws are removed, lower the tail gate and carefully remove the wing.

2. Install the color-coded standoffs that came with your ADF Customs Drag Wing Kit.

- a. Standoff installation notes:
 - **Leave all fasteners loose until the end of the install.** They will need some free-play during the installation.
 - The ADF Customs Drag Wing uses the same mounting holes as the OEM wing.
 - Be sure to install the fasteners correctly, in the correct order. *(The flanged torx screw, lock washer and metal washer should be inside the tailgate, threading through the tailgate and neoprene washer into the standoff. The neoprene washer is meant to waterproof the hole under the standoff.)*



FIGURE 2 - WING FASTENER + STANDOFF LOCATIONS
 (INSIDE OF TAILGATE PICTURED, WITH PLASTIC TRIM REMOVED)

- On the three central locations (blue and green), take extra care not to drop the washers or torx screws inside the tail gate. They may never come out.

- b. Starting driver's side to passenger side, install the standoffs in the following order: red, yellow, green, blue (center), green, yellow, red. Refer to **Figure 2** for install locations.

3. Cover the remaining/unused holes. This will help prevent water from getting inside the tailgate.

- a. Clean and dry around the five remaining/unused holes in the tailgate. Failure to clean the surface properly could result in poor adhesion and subsequent leaks.

The unused holes accepted alignment pins on the OEM wing and will not be used for the new drag wing.

- b. Using the provided black vinyl stickers, cover the unused holes.

4. Install the ADF Customs Drag Wing.

- a. Hold the wing in position. **Starting with the center standoff** and working your way out, install the seven hex-drive screws one at a time. The blue (center) standoff, left-green, right-green, left yellow, etc.

It is helpful to have an assistant help hold the wing in place while getting the first few screws started.

- b. As you go along, use a 3/4" wrench to turn the standoff so the angled top matches the underside of the wing. When the angle matches, the hex-drive screw can be lightly snugged in place (fully tighten at the end of the install).

- c. When all standoffs correctly match the wing and are snugged in place, the standoffs can be fully tightened inside and out. We suggest holding the standoff with a wrench while tightening the torx screw inside.
5. **Install the tail light assembly.**
 - a. Connect the car's electrical connector to the connector on the provided tail light assembly.
 - b. Connect the washer fluid hose to the washer nozzle on the new tail light assembly.
 - c. Route all of the wires and washer fluid hose through the resistor bracket. Then, attach the bracket to the wing using the small, black hex-drive screws provided. An additional cable tie or two may be desired.
 - d. Using two more of the small hex-drive screws, attach the tail light bracket to the wing.
 6. **Double-check to ensure all fasteners are secure (*Tighten everything!*), verify tail light functions properly, and check the washer nozzle.**
 - a. Double-check seven torx screws on the inside of the tailgate, and twelve on the outside of the wing (seven w/ 4mm driver, and five w/ 3/32" driver).
 - b. Have an assistant help ensure the tail light and brake light are operating correctly.
 - c. Check the function of the rear washer nozzle and adjust the direction of the spray if necessary.
 7. **Reinstall the plastic trim panel inside the tailgate** (above the rear window).
 8. Head to the track and enjoy your new ADF Customs Drag Wing!

Thank you for choosing ADF Customs! We appreciate your business. Should you have any questions, issues or feedback, please email us at: [**info@adfcustoms.com**](mailto:info@adfcustoms.com)

If you are happy with your ADF Customs product and customer experience, please leave a review or share online via your favorite forum, Facebook or Instagram.