



2015-2018 Focus ST Front Splash Guard

Installation Instructions

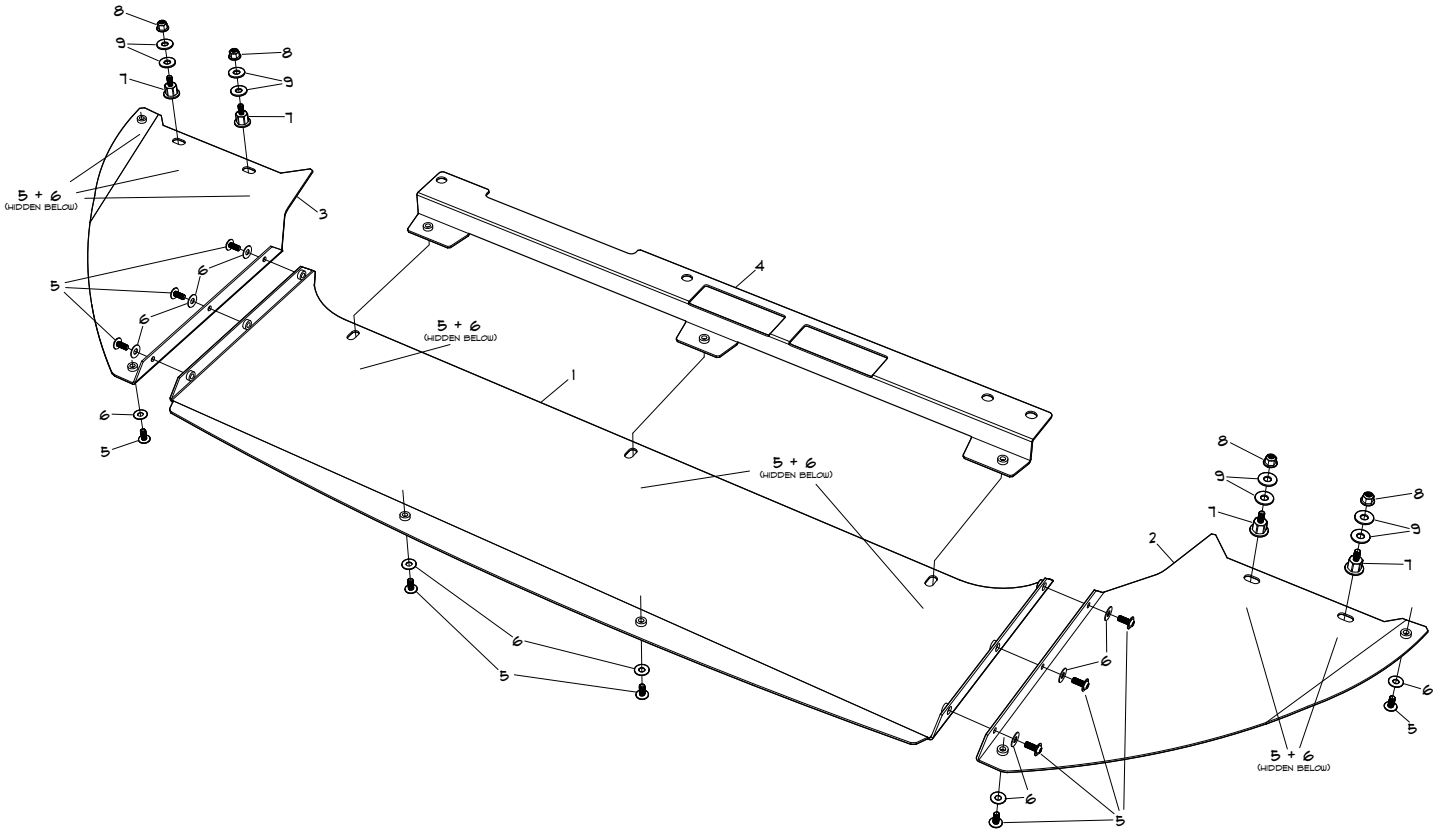

FIGURE 1 - FRONT SPLASH GUARD PARTS DIAGRAM

Part	Description	Quantity
1	Front Splash Guard (center)	1
2	Driver's Side Panel	1
3	Passenger Side Panel	1
4	Mounting Bracket	1
5	M6 x 14 mm Torx-Drive Screw	21 (includes 2 extra)
6	M6 Washer (6.4mm I.D., 18mm O.D.)	21 (includes 2 extra)
7	M6 x 12mm M/F Standoff	4
8	M6 Lock Nut	4
9	Fender Washer (5/16 I.D., 3/4" O.D.)	8

TOOLS NEEDED

Required Tools	Suggested Tools
T30 Torx driver	Small impact driver/screw driver
Small flathead screwdriver	T30 socket or T30 drive bit
Phillips screwdriver	7/16" Socket
13 mm wrench	Panel puller
10mm wrench	

INSTALLATION PROCEDURE

Please read entire installation procedure before you begin.

****Always wear safety glasses and appropriate protective equipment when performing these tasks****

- 1. Pre-assemble your ADF Customs Front Splash Guard.** Refer to the diagram in **Figure 1**.
 - a. Using three of the black M6 torx screws w/washers, secure the drivers side panel (*part #2*) to the center portion of the splash guard (*part #1*). Repeat this step for passenger side panel (*part #3*). Tighten all screws securely.

- 2. Secure your vehicle** on a lift, ramps or jack stands.

- 3. Remove your ADF Customs Skid Plate** or OEM engine splash guard.
 - a. Use a 7/16" socket or wrench, remove your ADF Customs skid plate. Alternatively, use a T30 torx driver to remove your OEM engine splash guard.
 - b. If you have previously installed an ADF Customs skid plate, remove the three 1" skid plate standoffs from the rivet nuts in the radiator support. These three standoffs are what hold the new splash guard mounting bracket (*part #4*).



FIG. 2 - FASTENER LOCATIONS; MOUNTING BRACKET

4. Remove the OEM front splash guard.

- a. Remove five plastic rivets from the front bumper cover. See **Figure 2** for locations circled in red.
- b. Remove T30 screws along the rear of the splash guard (*located in the radiator support, and in each fender liner*).
- c. The OEM splashguard can now be removed.

5. Install mounting bracket.

- a. Using a small flathead screwdriver, **remove all of the red plastic OEM inserts** from the radiator support. ****PLEASE NOTE: If you are not planning to use an ADF Customs Skid Plate, simply install the mounting bracket on the radiator support with the OEM Fasteners.****

- b. If you have previously installed an ADF Customs skid plate, proceed to next step. If you have not yet installed your ADF skid plate, install three rivet nuts into the radiator support now. Refer to **Figure 3** for rivet nut locations.
- c. Fix the mounting bracket in place with the same three 1" standoffs removed earlier (*the three front skid plate standoffs*). The installed mounting bracket is pictured in **Figure 2**.



FIG. 3 - RADIATOR SUPPORT WITH RIVET NUTS INSTALLED

- 6. **Install the four splash guard standoffs** (*part #7*). Refer to the **red** arrows in **Figure 4**. The standoff locations/orientation are indicated by the red arrows.
 - a. Remove the four clip nuts where the OEM splash guard was connected to the fender liners (*two on each side*).
 - b. Use the 3/4" o.d. fender washers (*part #9*) and locknuts (*part #8*) to install two standoffs in each fender liner where the clip nuts used to be.



FIG. 4 - STANDOFF LOCATIONS

7. **Install the ADF Customs Front Splash Guard.** **To ease installation, leave all of these fasteners slightly loose until the end**
 - a. With the mounting bracket and standoffs secured in place, fit the new splash guard into position.
 - b. Starting in the center and working your way out to the sides, thread six M6 torx screws w/ washers through the bumper cover into the new splash guard (*through the holes where the plastic rivets were previously*).
 - c. Install seven additional M6 torx screws w/washers through the splash guard, three into the mounting bracket and four into the fender liner standoffs.
 - d. Once all fasteners are in place and positioned correctly, **tighten all fasteners securely.**
8. With the front splash guard now complete, **install your ADF Customs Skid Plate** or OEM engine splash guard.
9. **Double check all fasteners** are secure and all tools are accounted for.

10. Enjoy your new Front Splash Guard and the added protection!!

Thank you for choosing ADF Customs! We appreciate your business. Should you have any questions, issues or feedback, please email us at: ***info@adfcustoms.com***

If you are happy with your ADF Customs product and customer experience, please leave a review or share online via your favorite forum, Facebook or Instagram.